

Ralph M. Casco
 Ralph W. McHugh

Evelyn Davis
 to
 Arnold W. Elizabeth A. La Ross
 30.30 Acres by planimeter
 excluding highway right of way

Evelyn Davis
 to
 Douglas H. Raquette
 Donald J. Johnson
 Perundean A. Raquette

Approx. True North
 Magnetic North 1917

Town of Johnson
 surveyed by Clyde Lampher 1914

Legend:
 o = iron pin set
 - - - = approx centerline of road
 — = blazed line
 + + + = fence

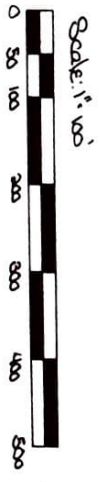

Chas. J. Thoma
 30x
 BK. 111 PA. 152
 BK. 24 PA. 514

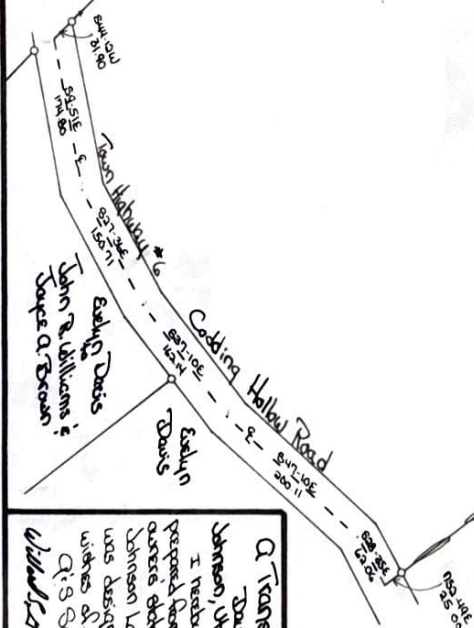

A Transit & Tape Survey
 Town to La Ross
 Scale: 1" = 100'

I hereby certify that this plat was prepared from a careful based upon field evidence, correct observations, research in the Johnson Land Records; this plat was designed according to the wishes of the Creator & Grantor of the Survey.

W. S. Swartzburg, Inc.
 Waltham, Mass. 01977

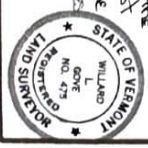

75