

Sheet No. 133 of survey done by Henry Shuman and the  
 supplemental survey of the St. Johnsbury and Lake Champlain R.R. Co.  
 and L.C.R.C. from line from survey of 1872-73 to the survey  
 of 1880-81.

RIGHT-OF-WAY AND TRACK MAP  
 OF THE ST. JOHNSBURY AND LAKE CHAMPLAIN R.R. CO.  
 Operated by  
 THE ST. JOHNSBURY AND LAKE CHAMPLAIN R.R. CO.  
 STATION 257+40 TO STATION 262+00  
 NEW YORK STATE JAN 1916  
 Office of State Engineer  
 Albany, N.Y.

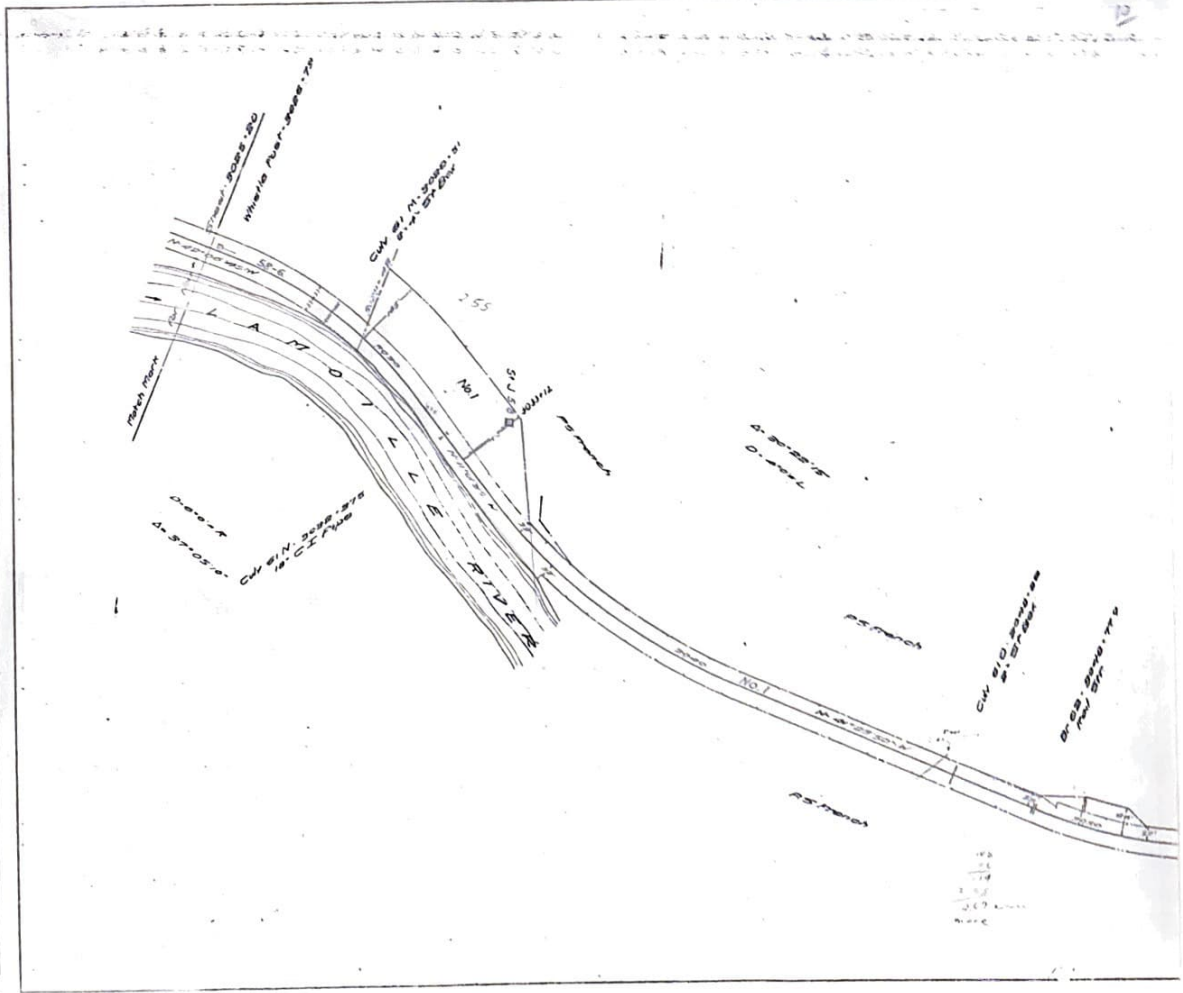

100  
 101  
 102  
 103  
 104  
 105  
 106  
 107  
 108  
 109  
 110